



Town of Rimbey Policy Manual

Title: Snow Removal

Policy No: 3101

Date Approved: January 22, 2019

Resolution No: 019/19

Date Effective: January 22, 2019

Purpose:

To establish a consistent, cost-effective standard of practice for clearing roads of snow and ice for safe travel within the corporate limits of the Town of Rimbey.

Policy Statement:

A system of labour, equipment and materials on a priority basis, in keeping with the requirements of the Town and Alberta Transportation shall be adopted.

Procedures:

A: Communication/Execution

1. General Public - Public Works will monitor conformance to this policy, exercise judgment in interpretation of this policy and periodically recommend changes to this policy when required.
2. The Public Works Department equipment and or Contractors hired by the Town of Rimbey may clear snow at any time.

B Road Priorities

1. **Road Priorities** – as outlined on attached map – There may be snowfall events which exceed the capacity of available manpower and equipment to carry out the work listed under each priority within the time allotted; the order of priority will not change in such a case.

Priority 1 – Snow plowing and removal as required, at 10 cm service level.

Priority 2 – Snow-plowing and removal within 48 hours following the end of a snowfall of 10 cm or greater service level. Snow will be removed off 50 ave at the conclusion of Priority 2 snow removal between 47th and 53 streets.

Priority 3 Residential - Snow plowing and removal within 120 hours following the end of a snowfall of 15cm or greater.

Priority 4 Back Alleys – Snow plowing and removal as required when rutting or drifting occurs, or when roadways and lanes become impassable due to accumulated snowfall, service level. **If snow accumulation is 122cm (4 feet) or greater, alleys will be closed and garbage service will be moved to the front streets. (Effective January 01, 2017)**

C: Service Level Roads

Roads

The sequence of clearing will be established at the discretion of the Public Works department within each priority category.

- a. On roadways with boulevards on both sides and no sidewalks on either side, snow windrows shall be plowed to and stored on either or both boulevards.
- b. On roadways with a centre median, snow shall be plowed to and stored on the median.
- c. On roadways with boulevards on both sides between the curb and sidewalk, snow windrows shall be plowed onto either or both boulevards.
- d. On roadways with a boulevard on one side and a monolithic sidewalk on the other side, the snow shall be plowed to the side with the boulevard only.
- e. On roadways with sidewalks on both sides, snow windrows shall be plowed adjacent to the sidewalk on roads edge at Public Works Directors discretion.
- f. Public Works may select locations for temporary snow storage where traffic **volumes, parking constrictions, multi-family development, roadway alignment constraints** or such like matters make snow storage within the road right-of-way **Inconvenient and unsafe**.

Driveways and Lane Crossings – Where a snow windrow is placed across a private driveway entrance, a public driveway entrance, the Town will open up the windrow at all such locations by pushing the majority of the snow to each or both sides of the crossing.

Laneways – When laneways become impassable or rutted or drifted in, the snow will be flattened and pushed by front-end loader.

D: Service Level Sidewalks

Priority 1 Sidewalk

50th-54th Ave to 50th Street East Side is deemed a priority One Sidewalk and will be maintained by Public Works for the benefit of the Kansas Ridge residents.

It is the responsibility of the property owner to remove snow from adjacent sidewalks as per Town of Rimbey Traffic Bylaw 951/18. The Town of Rimbey will not remove snow from any sidewalks, unless it was deposited on the sidewalk by Town snow removal crews.

E: Service Level Parking Lots

Parking lot cleaning will commence as part of Priority 2 clearing due to the facilities being essential components of the Municipal Emergency Plan for the Town of Rimbey.

Sand, Chips, De-icers

As road conditions become slippery, abrasives and/or melting agents may be applied at hazardous locations such as hills, curves and intersections if other techniques are ineffective or inappropriate. The application is done on a priority basis similar to snow removal.

F: Service Level Downtown Business District

The Business District shall be identified as:

- East/West Highway 53 extending east to Highway 20 and west to the Town limits.
- South of 4 way stop to 45th ave;
- North of 4-way stop to 51 ave;
- 50th street from 49th ave to 52nd ave;
- 49th ave from 49th street to 51 street;
- 49th street from 50th ave to 48th ave.

1. Businesses

- **Businesses are permitted to shovel their sidewalk to curb edge;**
- **Snow will be removed as per Road Priority 2;**
- **Businesses engaging contractors to clear their lots will NOT be allowed to push snow from their properties, onto roadways, and/or Town property;**
- **Contractors are allowed access to the Town’s snow storage site at no charge and must phone ahead to make arrangements.**

Contractors

- **Contractors hauling snow to the Town snow storage site must have commercial equipment, insurance satisfactory to the Town and use at their own risk.**

Bylaw 951/18

13.8 At all times, Snow Clearing Equipment and Street Sweeping Equipment of the Town of Rimbey, and or Contractors hired by the Town of Rimbey, shall have the right of way on Rimbey streets unless so directed by a Peace Officer or a Traffic Flag Person.

Initial Policy Date:	August 22, 2011	Resolution No:	193/11
Revision Date:	November 23, 2015	Resolution No.	393/15
Revision Date:	December 10, 2015	Resolution No.	402/15
Revision Date	January 22, 2019	Resolution No	019/19

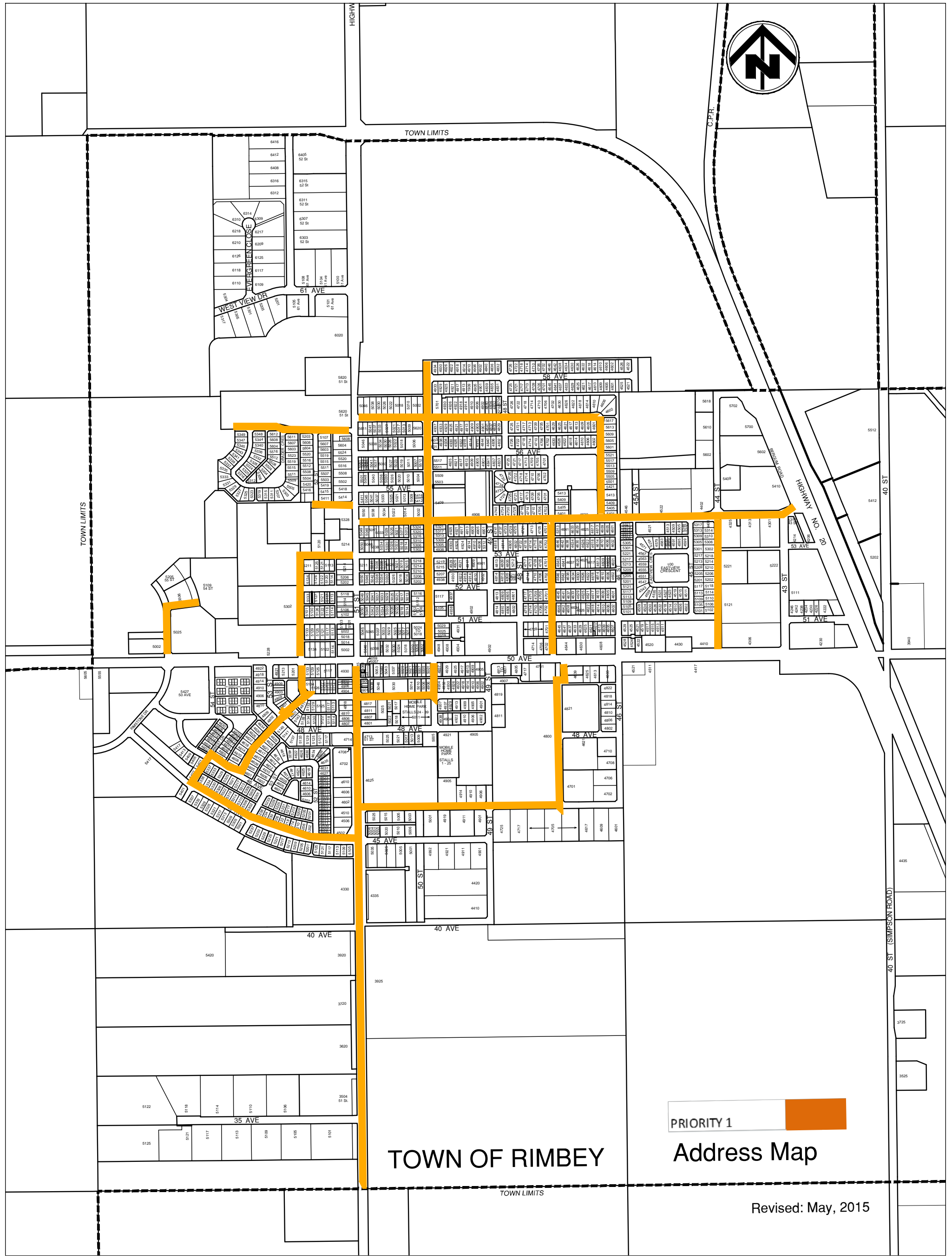
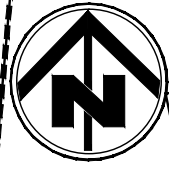

TOWN OF RIMBEY

PRIORITY 1 
Address Map

Revised: May, 2015

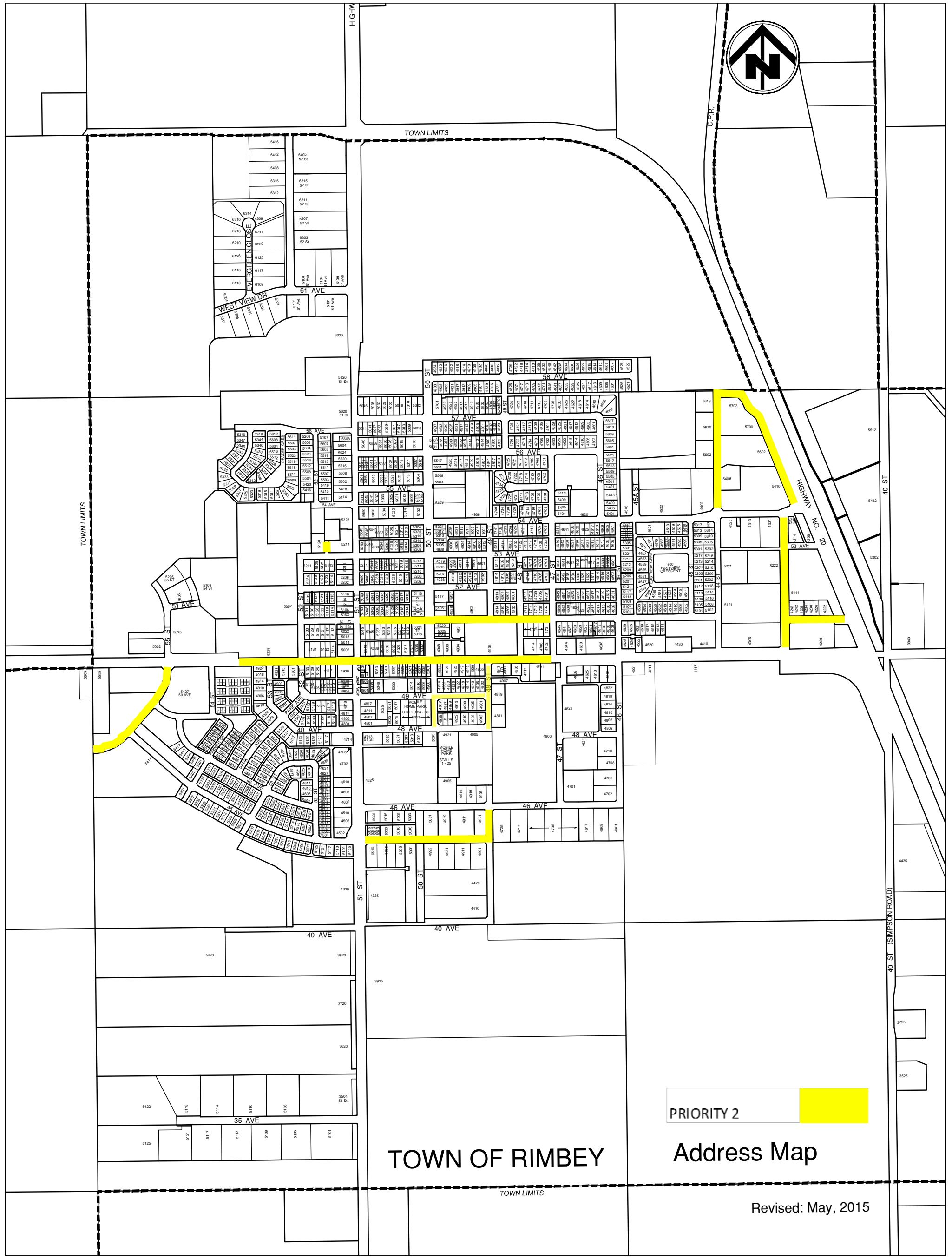

PRIORITY 2 

TOWN OF RIMBEY

Address Map

Revised: May, 2015

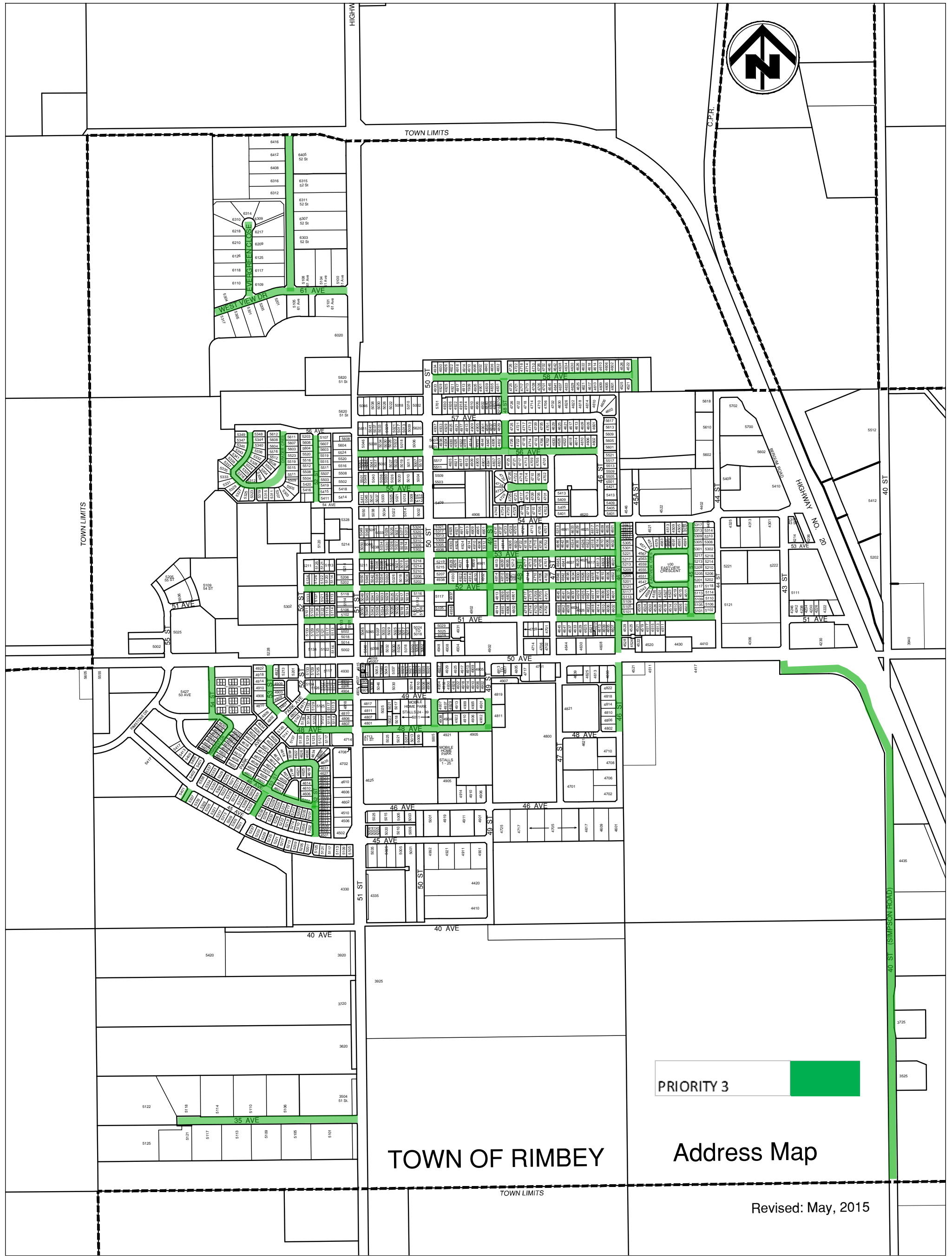

PRIORITY 3 

TOWN OF RIMBEJ

Address Map

Revised: May, 2015

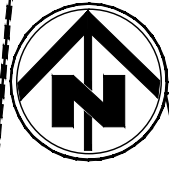

TOWN LIMITS

TOWN LIMITS

40 ST (SIMPSON ROAD)

PRIORITY 4

TOWN OF RIMBEY

Address Map

Revised: May, 2015

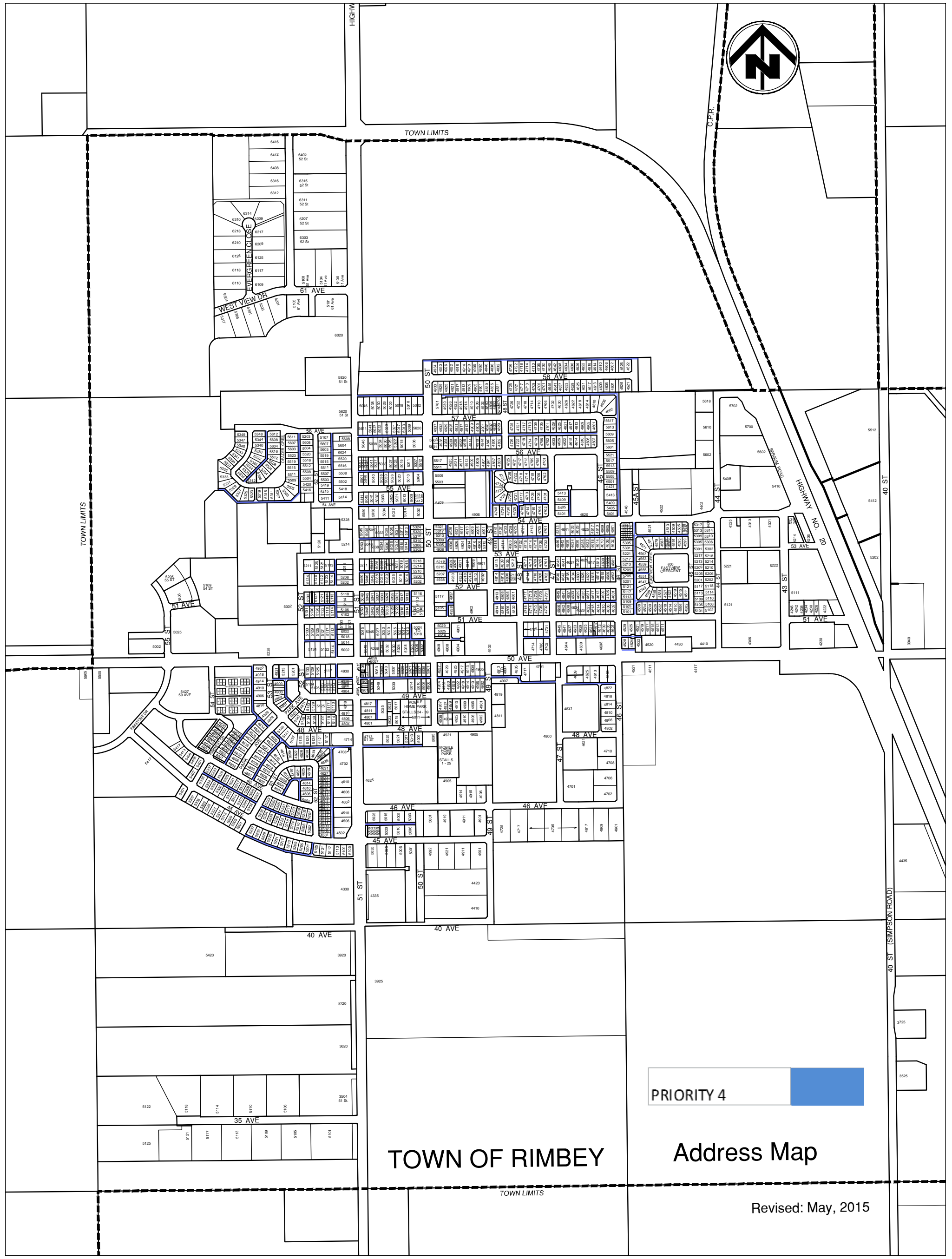

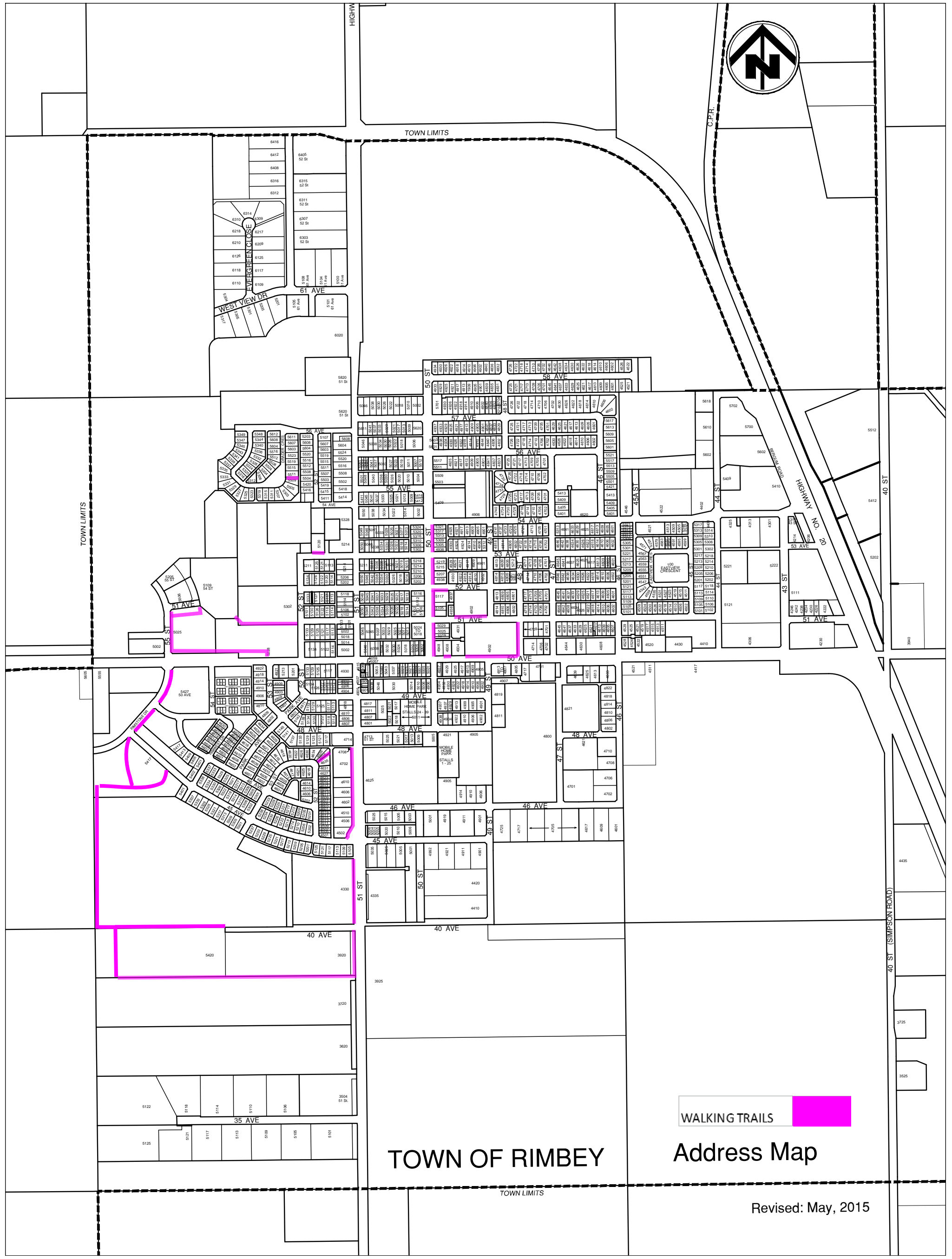

TOWN OF RIMBEY

WALKING TRAILS 
Address Map

Revised: May, 2015

