



NOTICE TO RESIDENTS

TOWN OF RIMBEY

2013 INFRASTRUCTURE REPLACEMENTS AND STREET IMPROVEMENTS

PLEASE BE ADVISED THAT THE TOWN IS CURRENTLY PLANNING WORK
IN 2 LOCATIONS AS SHOWN ON THE ATTACHED PLAN FOR THE
UPCOMING CONSTRUCTION SEASON

DETAILS AS FOLLOWS:

1. Road re-construction and paving will be done at the 58th Avenue location, east of 48th Street. The existing sanitary main will also be re-lined on this Street.
2. Stormwater construction along with road work will be done on the service road off of Highway 20, south of the 58th Ave. intersection.
3. There will be no disruption to residential water services at these locations.
4. The general contractor for this work is Border Paving. Border Paving will be in direct contact with these residents during the construction process.
5. Please find alternate parking when work is being completed in the area.
6. Border Paving is tentatively planning on 58th Ave. re-construction starting the week of June 3, 2013. Stormwater construction on the service road south of 58th Ave. will occur likely in the month of June.
7. Various asphalt patching will be done throughout Rimbey at this time, (not shown on the location plan).
8. Safety is top priority for the Town and we would ask all residents especially ones with children to keep a safe distance away from the construction sites and equipment.

Thank you for your cooperation.

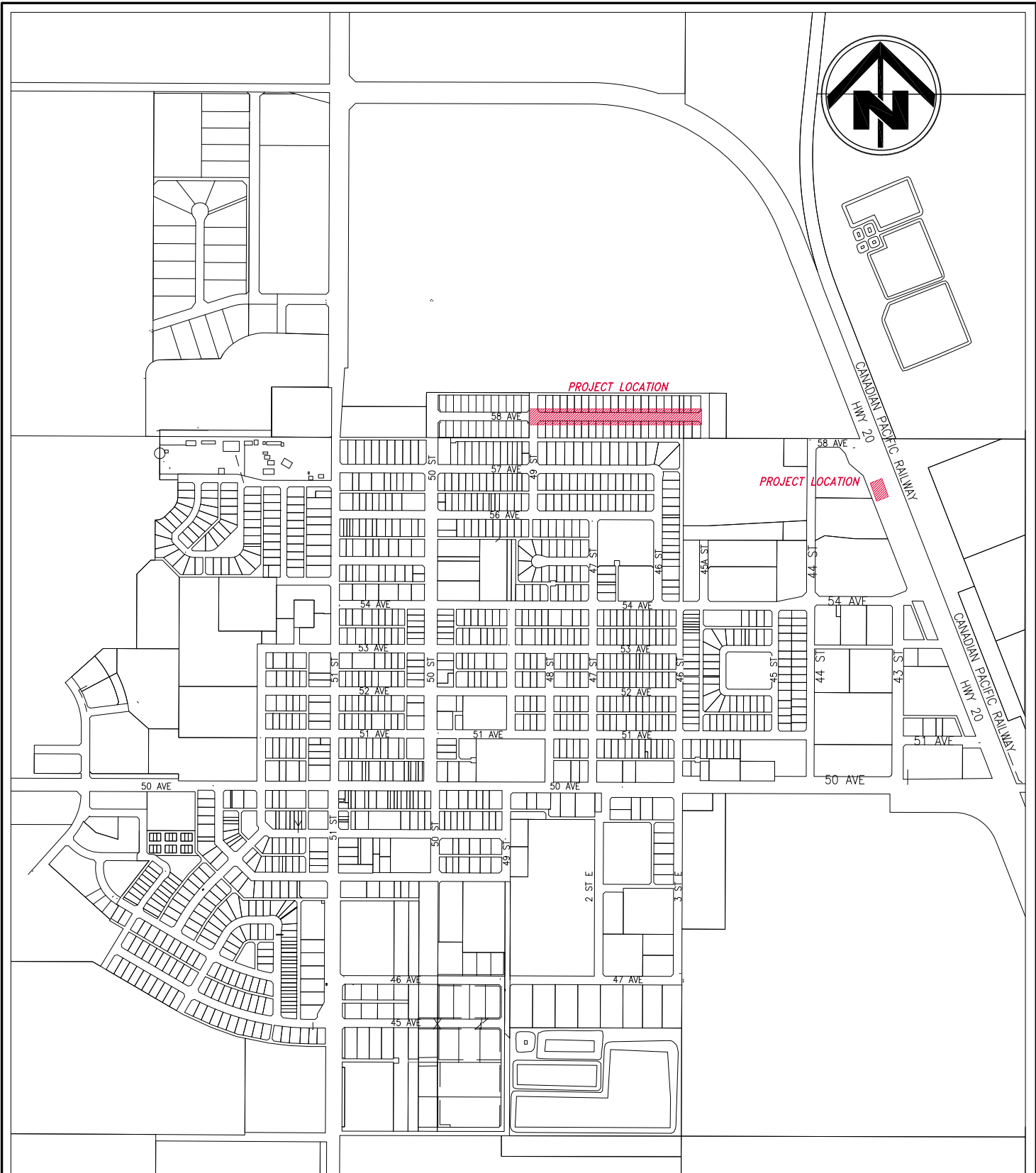

G4, 5550 - 45 St.
RED DEER, AB T4N 1L1

Ph: (403) 346-7710
Fax: (403) 341-4909
E-mail: admin@tagish-engineering.com

Client
TOWN OF RIMBEY

Project
58 AVE. RECONSTRUCTION

Drawing
PROJECT LOCATION PLAN

Scale: NTS	Date: April 3, 2013	Drawing No. 1
Drawn: LS	Project No.: RB109	
Designed: LS	Dwg File: RB109_LOCATION PLAN_MAY 24, 2013	
Checked: GS		
Approved: LS		